

# Care Roll Holder

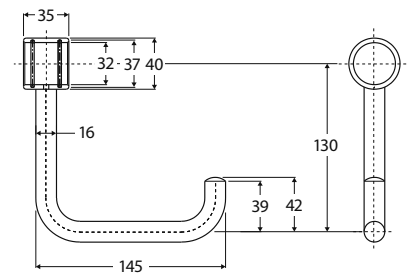

## FC03

- Designed to be fixed to Care Hand Rails & Grab Rails
- Manufactured to comply with relevant grab rail requirements for AS 1428.1:2021 Access and Mobility
- Made from 304 stainless steel
- Suits FC30, FC45, FC60, FC90, FC8357L, FC8357R, FC8357L-C, FC8357R-C, GRAB7094111L, GRAB7094111R, GRAB60103111L, GRAB60103111R



## Important

The Fienza Care Toilet Roll Holder is only suitable for installation on grab rails that have a 32mm diameter.

To install the Fienza Care toilet roll holder onto the Fienza Care grab rail, this will firstly require partial disassembly of the grab rail to correctly fit the roll holder onto the rail.

The roll holder must be fitted to the grab rail, before the grab rail is installed onto the wall.

Please use the Silicone grease supplied with this roll holder to prevent the rail from being scratched when installing the roll holder to the rail.

## Cleaning & Care

- Clean regularly using a mild liquid detergent and water.
- Do not use cream cleaners or bleach. These substances are abrasive.
- Do not use cleaning pads with abrasive surfaces as this may scratch the materials.

**BEFORE INSTALLATION: CHECK ALL PARTS OF PRODUCT THOROUGHLY. INSTALLATION IS ACCEPTANCE OF GOODS AND WILL VOID WARRANTY. MIRRORS ARE FRAGILE. TAKE EXTRA CARE WHILE TRANSPORTING AND HANDLING GOODS.**

All installations should be carried out by a qualified tradesman in compliance with the National Plumbing & Drainage Code and any State or Local Authority Regulations, in accordance with AS/NZS 3500 series of standards and AS/NZS 6400. All measurements are in millimetres and are subject to change without notice. For ceramic products, please allow +/- 10 mm tolerance for manufacturing variance. Please refer to [fienza.com.au](http://fienza.com.au) for the latest product specification.

### Installation Instructions

Refer to the relevant Fienza grab rail model (Hand Rails or Grab Rails) for the correct instructions below.

#### Installation for FC30, FC45, FC60, FC90, FC8357L, FC8357R, FC8357L-C, FC8357R-C

1. Ensure the grab rail is in the correct orientation before disassembling the product (with Fienza logo facing on the topside).

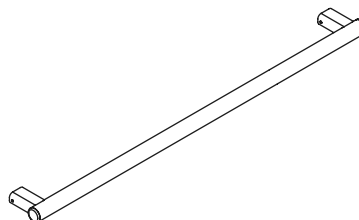

2. To slide the roll holder onto the rail, one of the mounting arms will need to be removed. Choose the correct mounting arm and remove the fixing bracket from inside the mounting arms by loosening the grub screws.

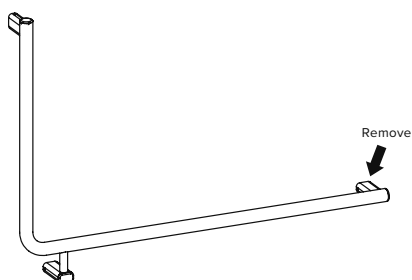

For FC8357 models, remove the mounting arm from the end of the horizontal longer 900mm length of the rail.

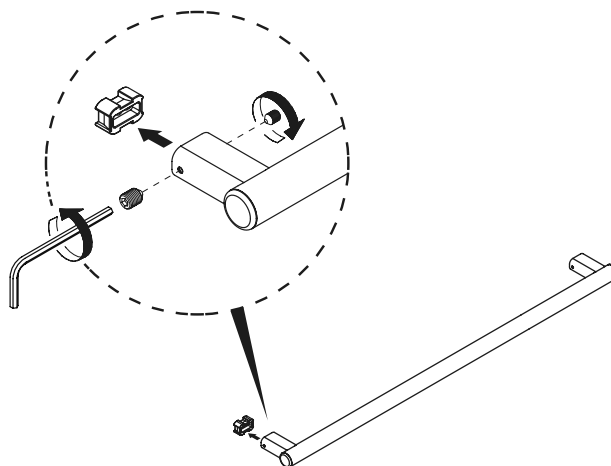

3. The internal hex head screw that attaches the mounting arm to the rail will need to be removed. Using a 6mm Allen key, remove the hex head screw from inside the mounting arm.

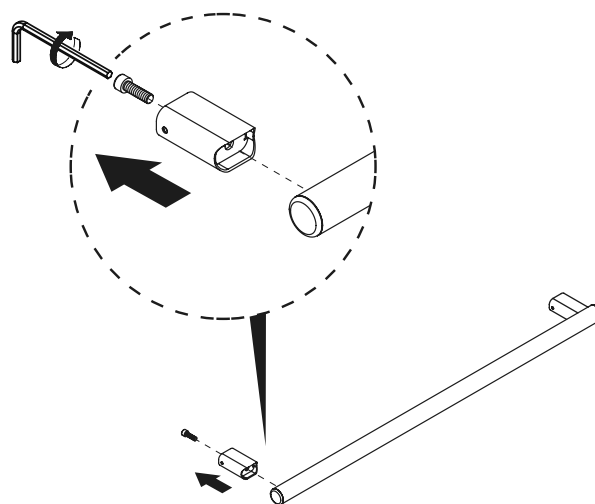
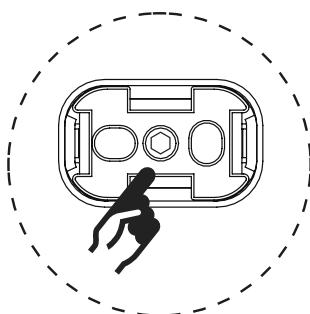

4. Take the silicone grease supplied with the roll holder and rub a pea sized amount onto the rail and onto the inside of the circular part of the roll holder.

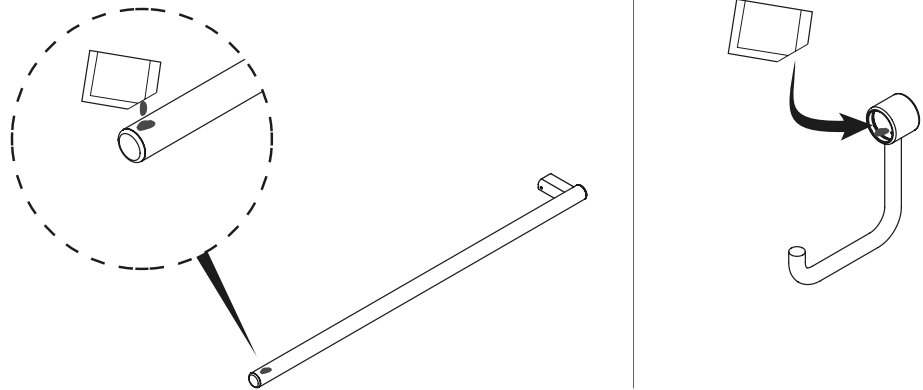

5. Push the roll holder onto the end of the grab rail and carefully slide it into the correct position ensuring placement meets AS 1428.1 standards if required.

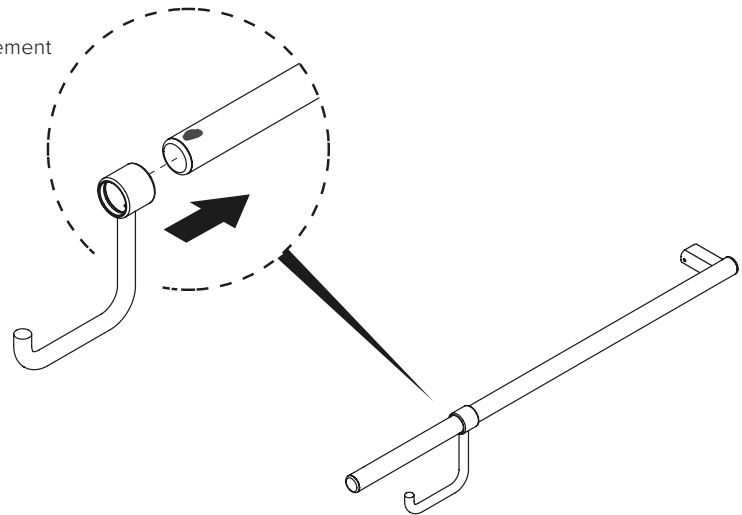

6. Using the 6mm Allan key, reassemble the mounting arm to the rail by firmly re-tightening the hex head screw to the rail, making sure that the mounting arm is in the correct position on the rail.

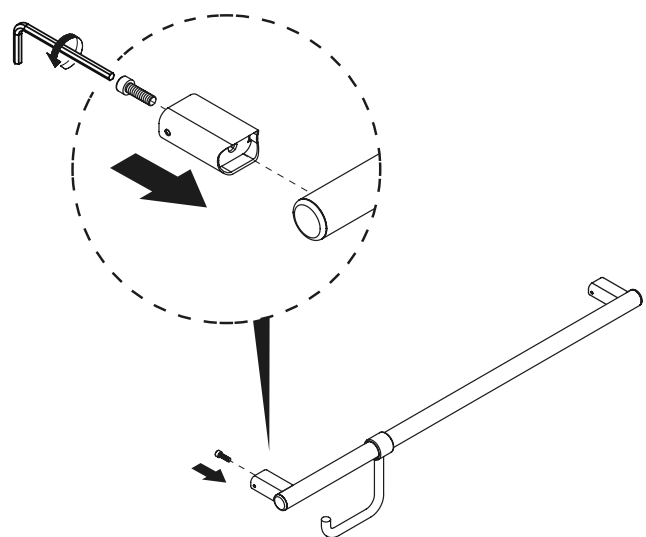

7. Clean the remaining silicone off the rail with a soft cloth and soapy water.  
 8. Install the grab rail to the wall using the Installation Guide provided with the rail and according to AS 1428.1 standards if required.

### Installation for GRAB7094111L, GRAB7094111LMB, GRAB7094111R, GRAB7094111RMB, GRAB60103111L, GRAB60103111LMB, GRAB60103111R, GRAB60103111RMB

1. Ensure the grab rail is in the correct orientation before assembling the roll holder to the rail.

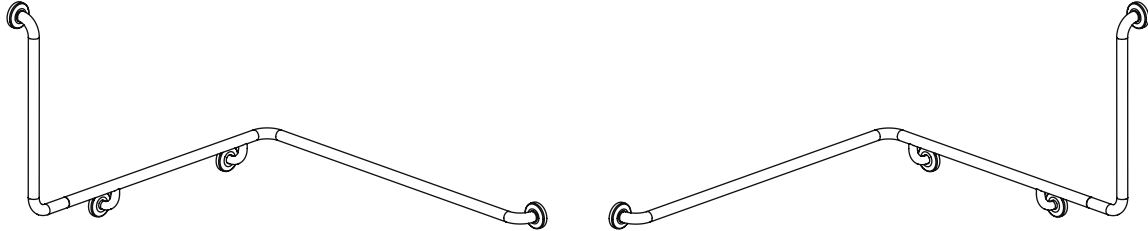

2. Take the silicone grease supplied with the roll holder and rub a pea sized amount onto the rail and onto the inside of the circular part of the roll holder.

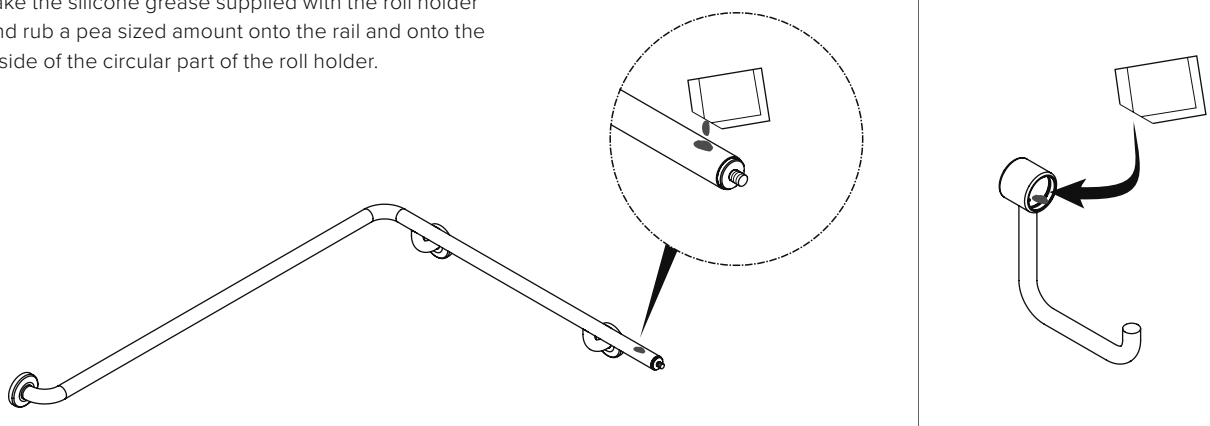

3. Push the roll holder onto the end of the grab rail and carefully slide it into the correct position ensuring placement meets AS 1428.1 standards if required.

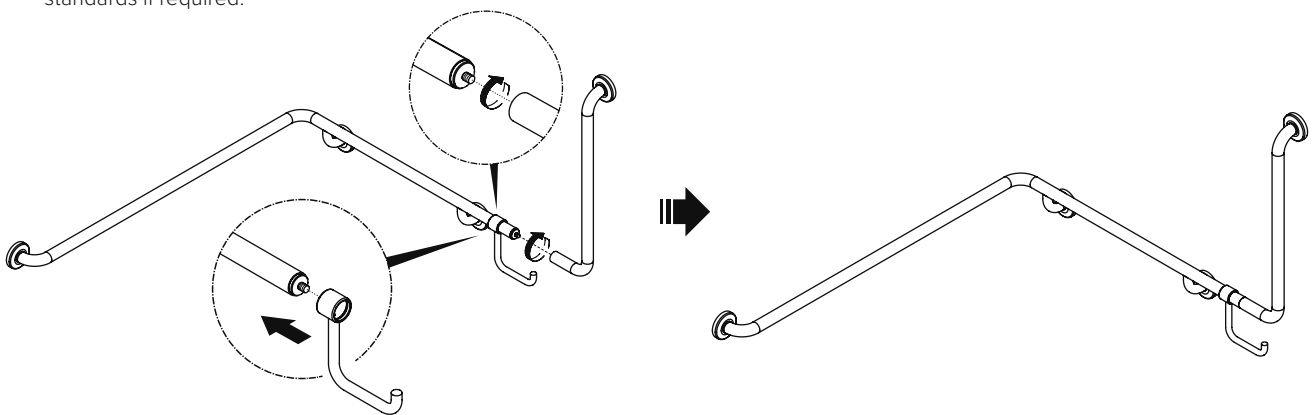

4. Clean the remaining silicone off the rail with a soft cloth and soapy water.
5. Assemble and install the grab rail to the wall using the Installation Guide provided with the rail and according to AS 1428.1 standards if required.

All installations should be carried out by a qualified tradesman in compliance with the National Plumbing & Drainage Code and any State or Local Authority Regulations, in accordance with AS/NZS 3500 series of standards and AS/NZA 6400. All measurements are in millimetres and are subject to change without notice. For ceramic products, please allow +/- 10 mm tolerance for manufacturing variance. Please refer to [fienza.com.au](http://fienza.com.au) for the latest product specification.

**THIS PAGE HAS BEEN INTENTIONALLY LEFT BLANK**

All installations should be carried out by a qualified tradesman in compliance with the National Plumbing & Drainage Code and any State or Local Authority Regulations, in accordance with AS/NZS 3500 series of standards and AS/NZA 6400. All measurements are in millimetres and are subject to change without notice. For ceramic products, please allow +/- 10 mm tolerance for manufacturing variance. Please refer to [fienza.com.au](https://www.fienza.com.au) for the latest product specification.

## Warranties

### Residential Warranty Periods

Applies to domestic uses and applications of Fienza® products, such as private dwellings and retirement villages.

### Commercial Warranty Periods

Applies to commercial uses and applications of Fienza® products, including, but not limited to: commercial food premises such as restaurants; commercial accommodation such as hotels; hospitals and healthcare facilities; public amenities; and industrial, laboratory and manufacturing facilities.

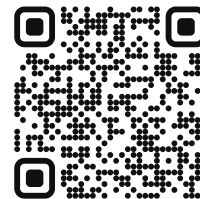

Full Warranty Terms

Product Component	Residential	Commercial
Structure Only	5 years replacement parts or product	5 years replacement parts or product
Finishes - PVD & Electroplated	5 years replacement parts or product	1 year replacement parts or product
Spare Parts	1 year replacement parts or product	1 year replacement parts or product

### Australian Consumer Law

Our goods include guarantees that cannot be excluded under the Australian Consumer Law. You are entitled to a replacement or refund for a major failure and compensation for any other reasonably foreseeable loss or damage. You are also entitled to have the goods repaired or replaced if the goods fail to be of acceptable quality and the failure does not amount to a major failure.

Fienza Pty Ltd reserves the right to make changes in product characteristics, packaging or availability at any time without notice. Please visit [fienza.com.au](http://fienza.com.au) for the latest information.

### Warranty Conditions

- Installation has been carried out by a licensed tradesperson in accordance with all applicable Building, Plumbing and Electrical codes, and Federal, State, or Local Government Regulations in accordance with AS/NZS 3500 Plumbing & Drainage, AS/NZS 6400 Water Efficient Products, and AS/NZS 3000 Electrical standards for any installations to which these standards apply.
- All maintenance and adjustments to the product after the installation have been carried out by a licensed tradesperson.
- All care and cleaning instructions have been adhered to as prescribed.
- All goods of substandard quality manufacture (excluding imperfections permitted within AS1976 - Vitreous China used in Sanitary Applications) will be credited or replaced by Fienza when advised within the warranty period, subject to prior inspection and agreement.
- Proof of purchase is required for warranty claims.

### Warranty Limitations

To the extent permitted under the Trade Practices Act and other relevant legislation, Fienza's liability is limited to:

- The cost of replacing the goods, or
- The cost of obtaining equivalent goods, or
- The cost of having the goods repaired.
- Fienza is not responsible for any lack of operation or performance of goods (or any loss or damage) where goods are used or adapted for use with other goods not supplied by Fienza.
- It is the responsibility of the customer and installer before installation to ensure that all components are correct and free of obvious visible faults.
- Fienza is not responsible for the labour and rectification costs incurred in the above circumstance.

### Conditions for On-Site Warranty Service Calls

Fienza will charge a service fee for each visit to an installation by its technician where it is determined that the fault is due to poorly executed or unlicensed installation work or where the product is not a genuine Fienza product or where the product is outside the warranty period. This may be paid in advance by credit card over the phone to a Fienza technician attending the site and will be refunded if the Fienza product is found to be at fault.

### PLEASE LEAVE THIS MANUAL WITH THE END USER

For warranty support, please contact Fienza  
 15 Walter Cres, Lawnton QLD 4501 | PO Box 5381, Brendale QLD 4500  
**P** 07 3490 6700 **F** 07 3490 6719 **E** [help@fienza.com.au](mailto:help@fienza.com.au) **ABN** 76 136 411 311